

Wadkin Sanding Machines

W/LC-2K

www.DaltonsWadkin.com



SPARE - PARTS

MAINTENANCE AND LUBRICATION

L.C.2.K

www.DaltonsWadkin.com

SPARE PARTS

www.DaltonsWadkin.com

PAGE

UNIT: TABLE WITHOUT SECTIONED
: FLOATING TABLES

PHOTO N° 1

1

REF.	NAME	
1.	Conveyor belt	
2.	Table	
3.	Drawing roller	
4.	Idle roller	
5.	Idle roller pin	
6.	Reduction gear Bonfiglioli MVF 86/P (without intermediate flange) r 1/40	
7.	Speed variator plate	
8.	Bell-shaped bearing	
9.	Screw - VCE - M8	
10.	Disk	
11.	Screw - VTE - M8	
12.	Washer	
13.	CHR 10 x 8 x 40	
14.	Shaft	
15.	Bearings 6008 - 2RS SKF	
16.	Inner circlips Ø 68	
17.	Screw M14	
18.	Bearing INA RCYT 30	
19.	Grease nipple	
20.	Locking ring	
21.	Bracket	
22.	Nipple	
23.	Securing screws	
25.	Belt centering membrane	

SPARE PARTS

www.DaltonsWadkin.com

UNIT: TABLE WITHOUT SECTIONED
FLOATING TABLES

PHOTO N° 1

REF.	NAME	
26.	Setscrew	
27.	Upper disk	
28.	Plate	
29.	Dowel	
30.	Nut	
31.	Screw M14	
32.	Bushing	
33.	Eccentric	

www.DaltonsWadkin.com

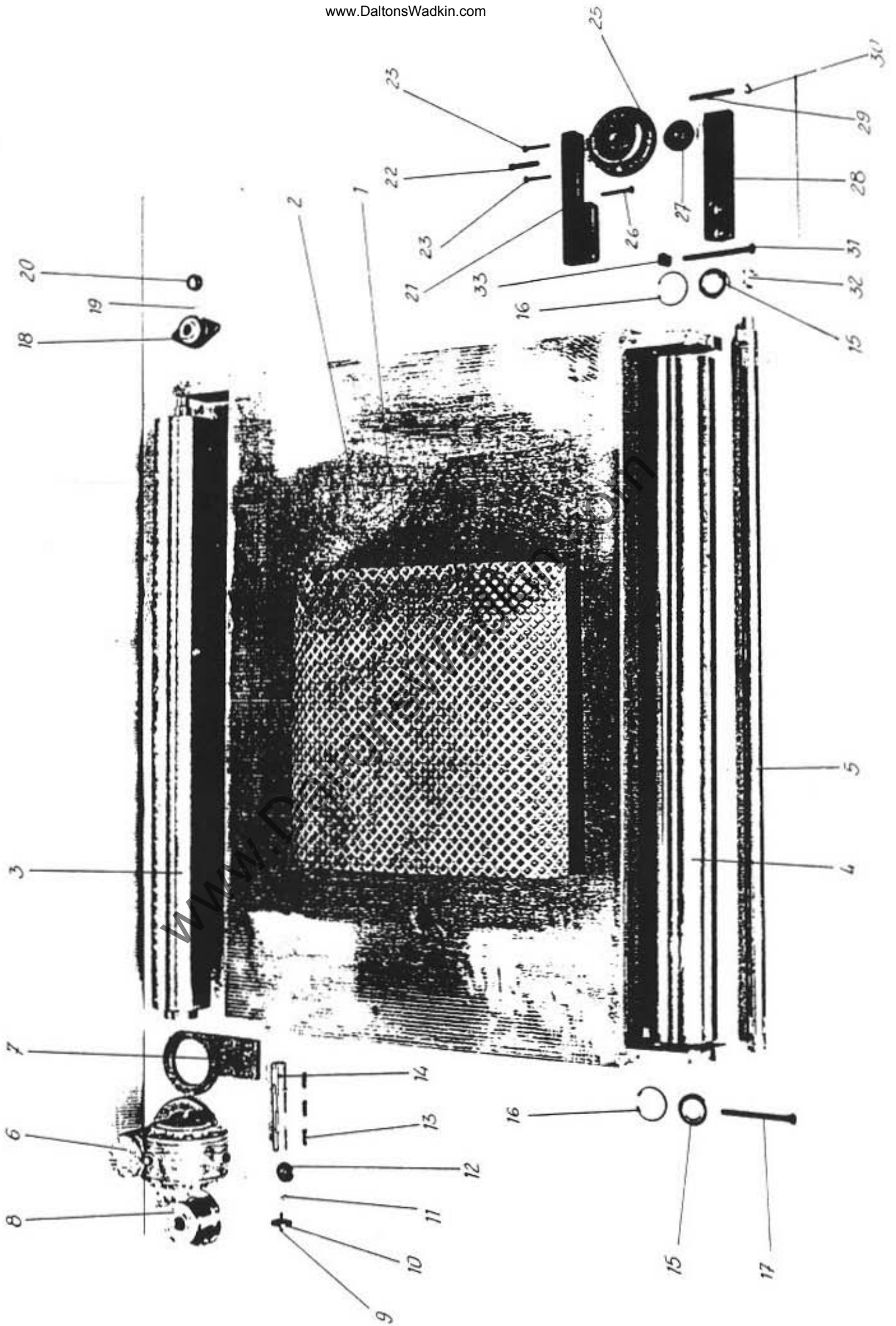

FIG. 1

SPARE PARTS

www.DaltonsWadkin.com

PAGE

UNIT: LIFTING

PHOTO N° 2

 1

REF.

NAME

- | | |
|-----|---|
| 1. | Motor HP 0.75 - 8 poles - flange Ø 160 - Shaft Ø 14 |
| 2. | CMV reduction gear with motor flange connection |
| 3. | CMV reduction gear without motor flange |
| 4. | Rubber bellow Drw. Nr. 700.1.33 |
| 5. | Connection shaft |
| 6. | Half coupling |
| 7. | Half coupling |
| 8. | Ring gear |
| 9. | Security dowel |
| 10. | Security dowel |
| 11. | Circlip I 17 |
| 12. | Chain 1/2" |
| 13. | Indicator square transmission |
| 14. | Indicator sheathing |
| 15. | Indicator vitor Alfa 8/4 |

www.DaltonsWadkin.com

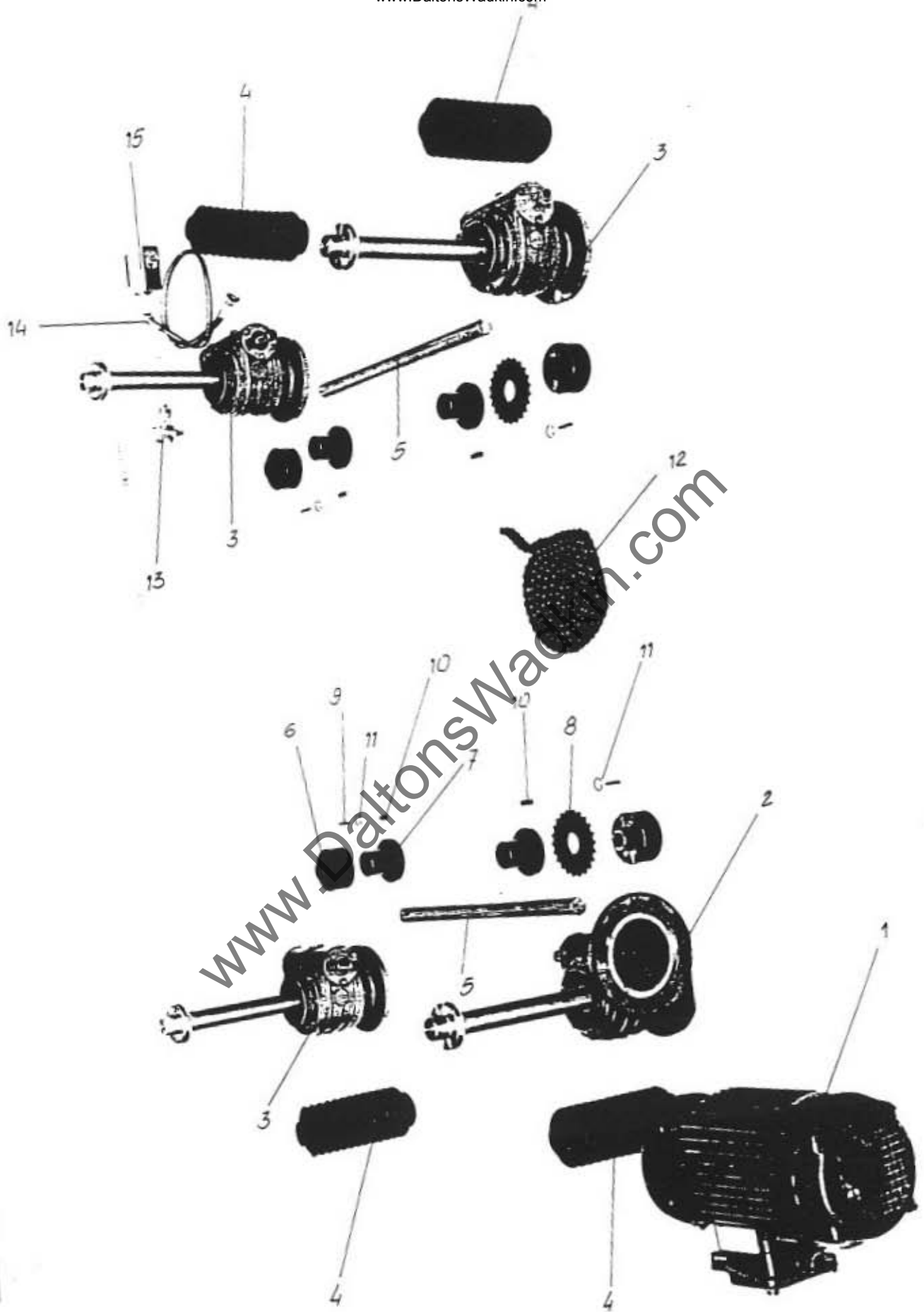

FIG. 2

SPARE PARTS www.DaltonsWadkin.com

PAGE

UNIT: CONTROL BAR

PHOTO N° 3

1

REF.

NAME

1. Supporting bar
2. Control roller
3. Control presser roller (rubberized)
4. Threaded web
5. Bearing
6. Radial rigid ball bearings 6000-2RS/SKF
7. Ball casings INA KH 2030
8. Inner circlips Ø 26
9. Outer circlips Ø 10
10. Sealing rings INA G 20 x 28 x 4
11. Lock nuts M 20
12. Lock nut M 6

www.DaltonsWadkin.com



FIG. 3

SPARE PARTS

www.DaltonsWadkin.com

PAGE

1

UNIT: ENTRY PLATEN

PHOTO N° 4

REF.	NAME	
1.	Entry platen	
2.	Platen rod	
3.	Platen plate	
4.	Entry platen bearing	
5.	Clamping plate	
6.	Platen adjusting screw	
7.	Adjusting bolt	
8.	Pointer	
9.	Radial rigid ball bearing 63007-2RS	
10.	Outer circlips Ø 35	
11.	Springs	
12.	Handle Jaccard M10	
13.	Threaded bar M12	
14.	GPE M 12 x 70	
15.	Lock nut M24	
16.	Lock nut M12	

www.DaltonsWadkin.com

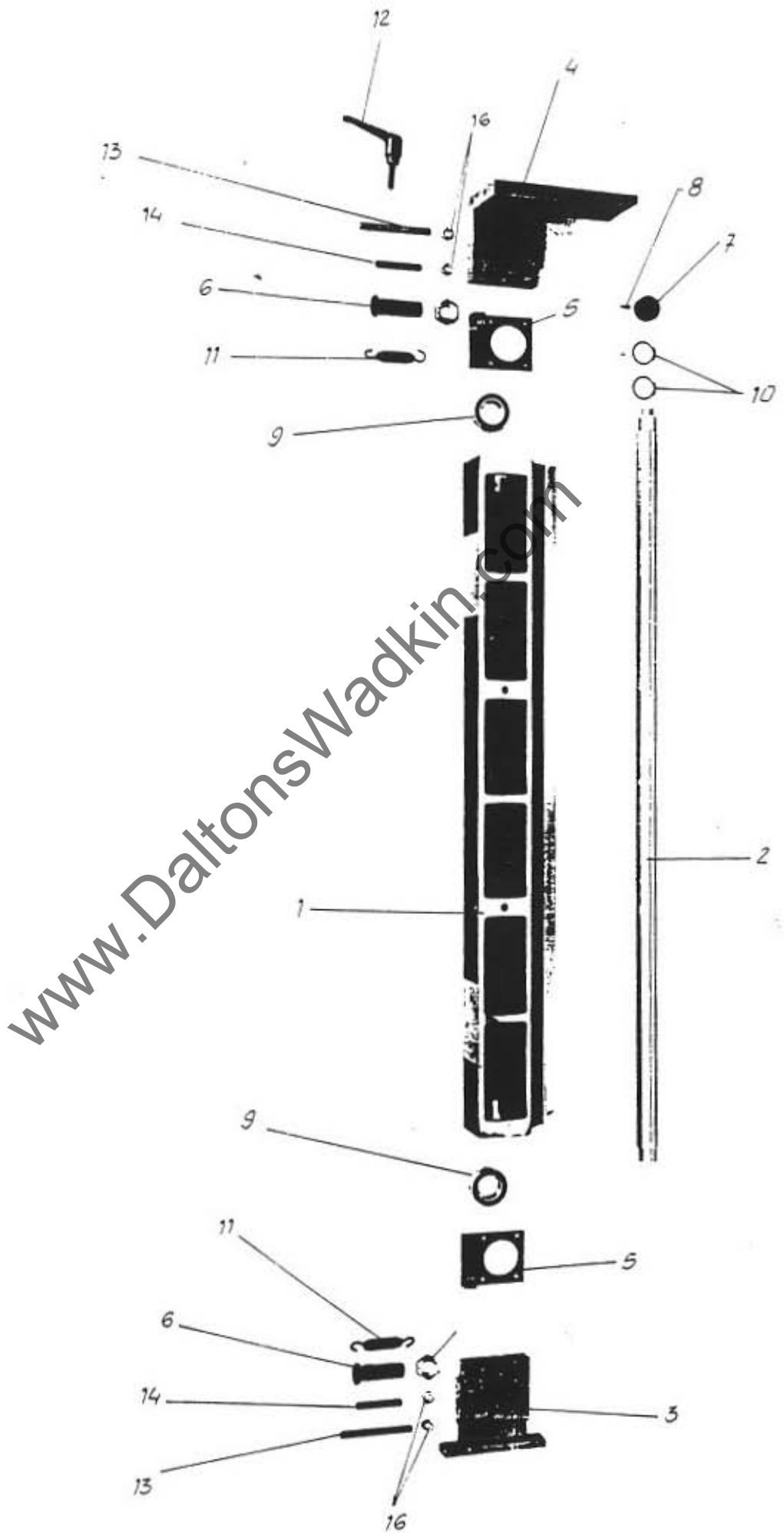

FIG. 4

SPARE PARTS

www.DaltonsWadkin.com

PAGE

1

UNIT: UPPER BEARING

PHOTO N° 5

REF	NAME	
1.	Upper roller	
2.	Upper roller rod	
3.	Bearing SKF 6308-2RS	
4.	SI Ø 90	
5.	Upper bearing	
6.	CD M12	
7.	RN Ø 12	
8.	OR 185	
9.	RN Ø 12	
10.	CD M12	
11.	CD M12	
12.	CD M12	
13.	Threaded bar M12	
14.	Piston	
15.	Cylinder	
16.	Threaded bar M12	
17.	CD M12	
18.	CD M12	
19.	CD M12	
20.	RN Ø 12	
21.	RN Ø 12	
22.	CD M12	
23.	Oscillation rod	
24.	Stop bracket	
25.	SE Ø 40	

SPARE PARTS

www.DaltonsWadkin.com

PAGE

2

UNIT: PAD DESCENT

PHOTO N° 5

REF

NAME

- 26. Rigid pad graphitized cloth
- 27. Pad adjustment springs BRW 700.8.35 (not illustrated)
- 28. Rod

www.DaltonsWadkin.com

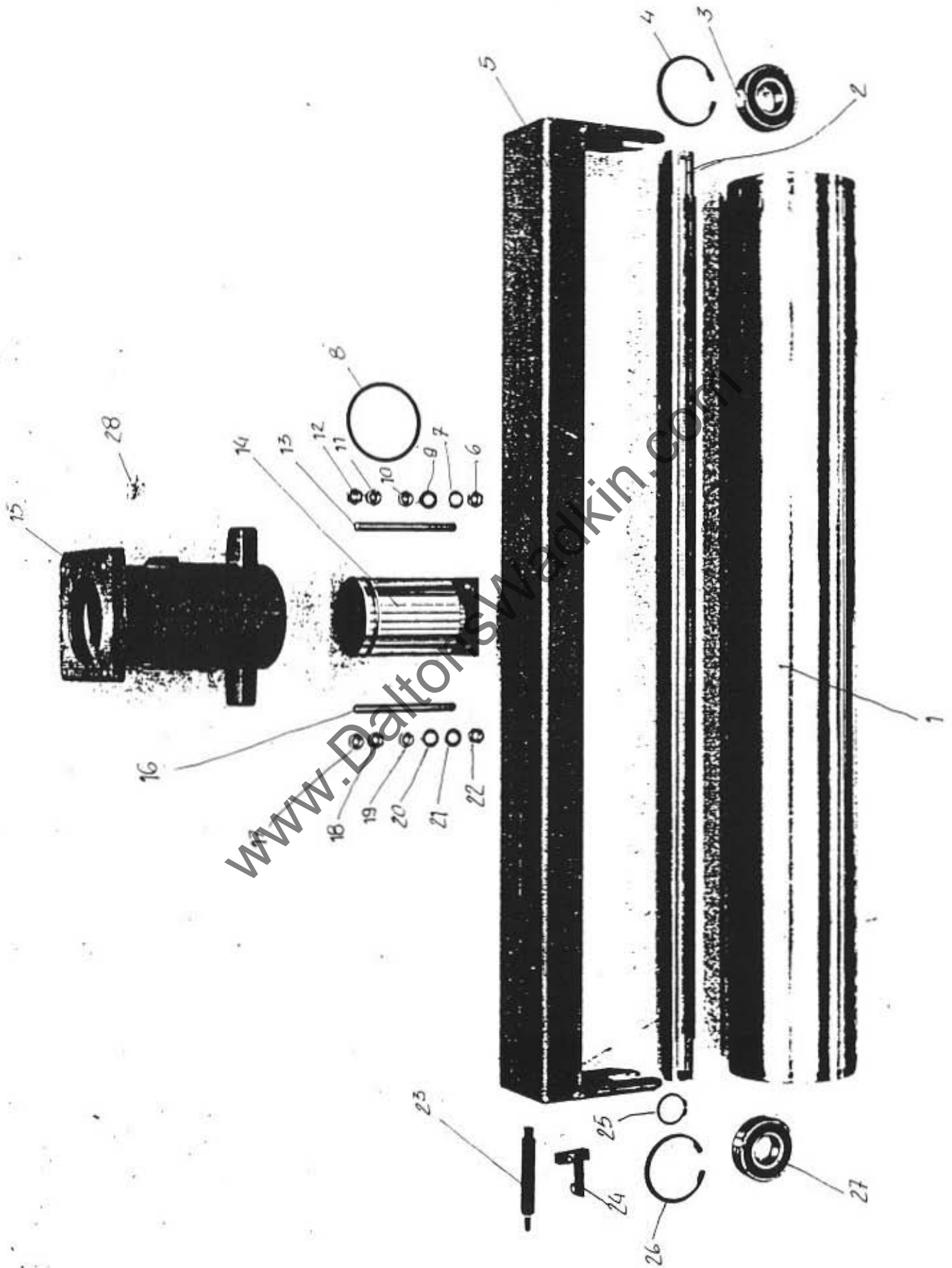

FIG. 5

SPARE PARTS

www.DaltonsWadkin.com

PAGE

UNIT: PAD DESCENT

PHOTO N° 6

 1

REF

NAME

- | | |
|-----|---------------------------------|
| 1. | Locking handle |
| 2. | Spring pin |
| 3. | Washer |
| 4. | Check pin |
| 5. | Clamping block |
| 6. | Pointer |
| 7. | Pointer holder cup |
| 8. | Adjustment lever |
| 9. | Spring pin |
| 10. | Pad adjustment eccentric |
| 11. | Adjustment nut |
| 12. | Washer |
| 13. | Guide bearing |
| 14. | Sealing ring INA G 25 x 35 x 4 |
| 15. | Gasket OR 4300 |
| 16. | Pad descent cylinder |
| 17. | Air nipple |
| 18. | CHR 8 x 7 x 25 |
| 19. | Gasket OR 4312 |
| 20. | Rod bearing |
| 21. | Gasket OR 6237 |
| 22. | Air nipple |
| 23. | Cylinder bottom plate |
| 24. | Pad section support rod |
| 25. | Pneumatic pad graphitized cloth |

www.DaltonsWadkin.com

SPARE PARTS

www.DaltonsWadkin.com

PAGE

2

UNIT: UPPER BEARING

PHOTO N° 6

REF.	NAME	
26.	SI Ø 90	
27.	Bearing SKF 6308-2RS	
28.	Air nipple	

www.DaltonsWadkin.com

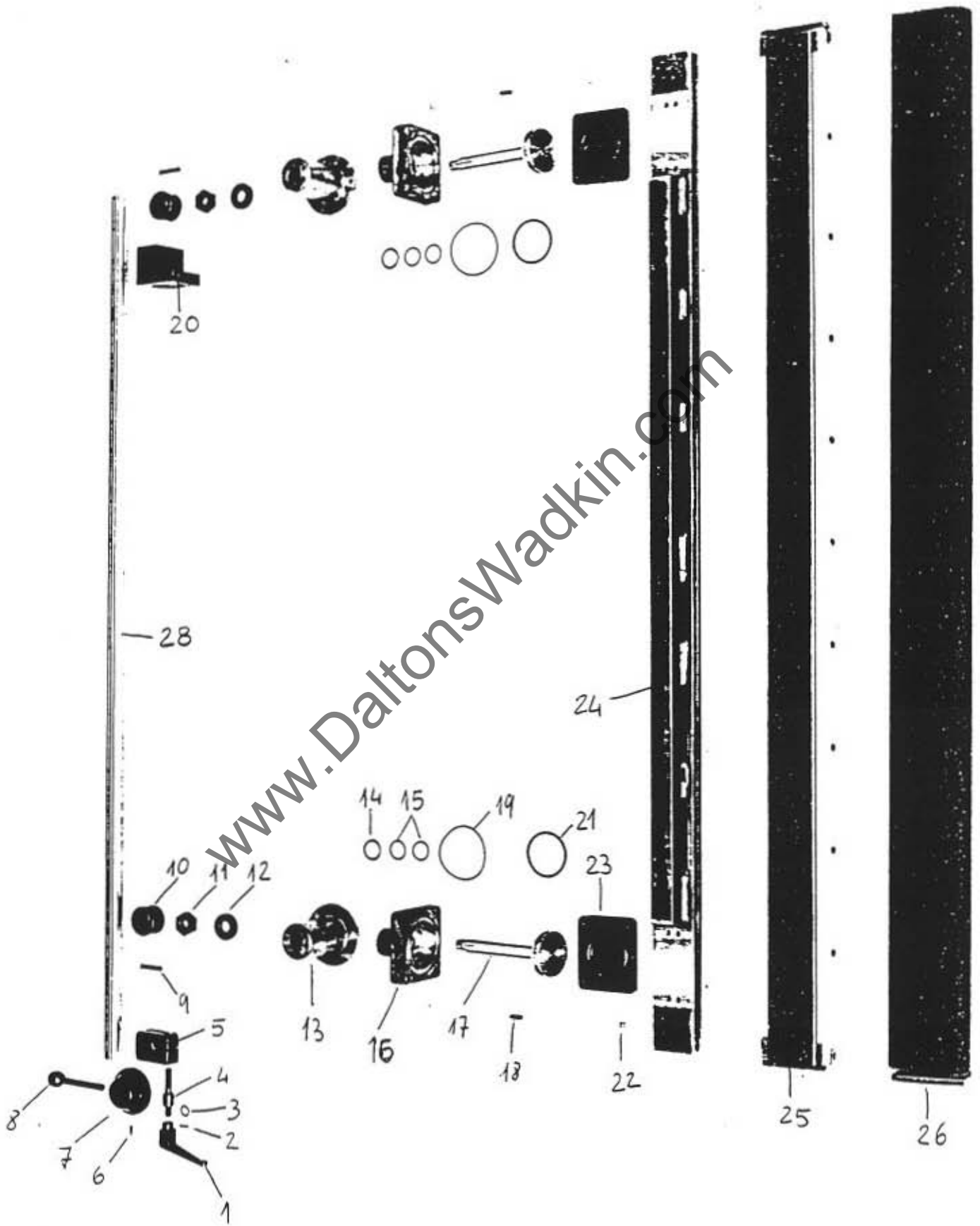

FIG. 6

SPARE PARTS www.DaltonsWadkin.com

UNIT: ROLLER POSITIONING

PHOTO N° 7

REF	NAME	
1.	Cylinder hinged bearing	
2.	Cylinder cetop DIN 1301 - Ø 6.3 - 75 - 08	
3.	Rack	
4.	Stop group with four positions	
5.	Circlip I 47	
6.	Bearings SKF 6005-2RS	
7.	Counter rack bushing	
8.	Eccentric nut	
9.	Securing screw	

www.DaltonsWadkin.com

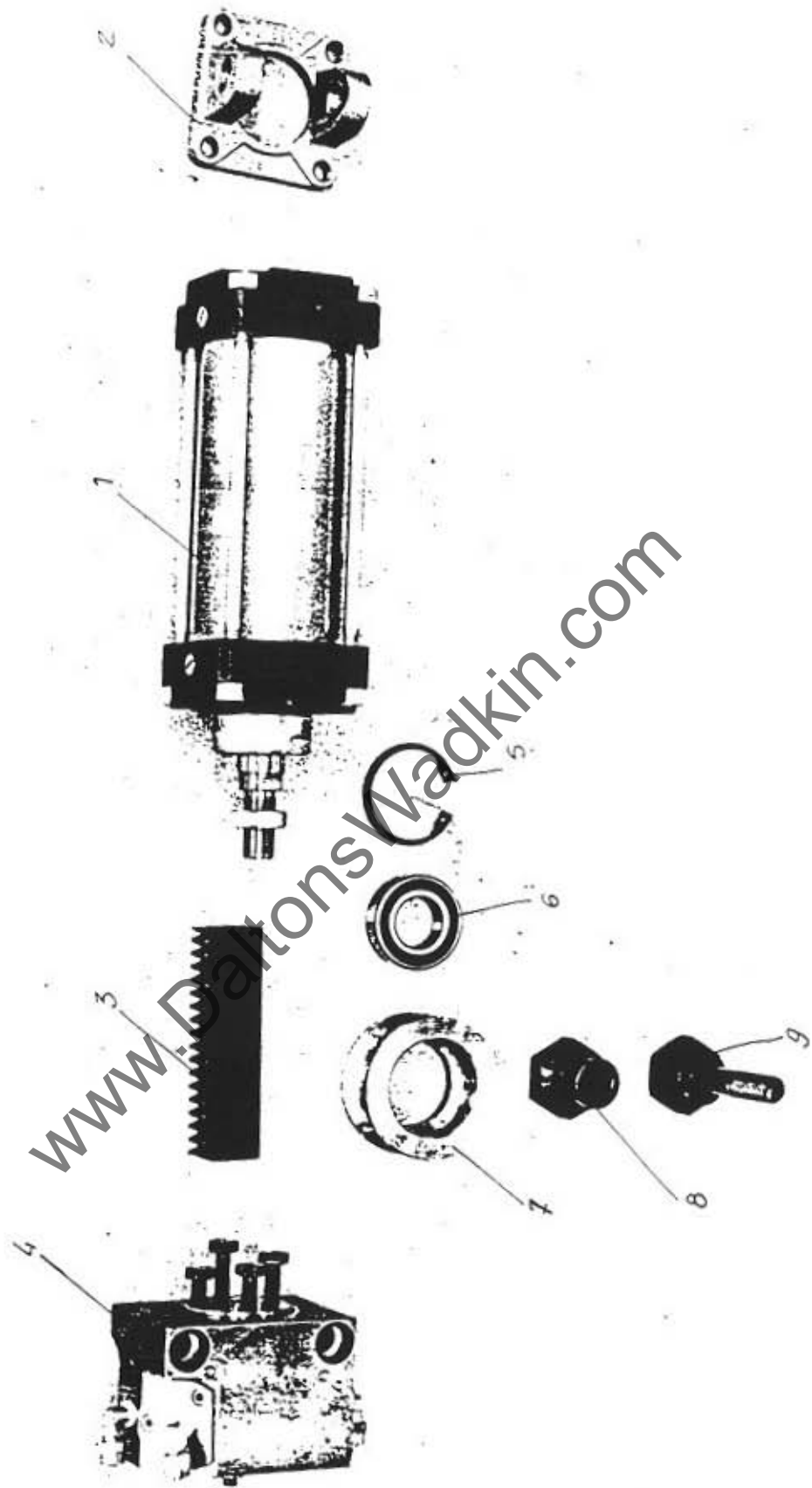

FIG 7

SPARE PARTS

www.DaltonsWadkin.com

PAGE

UNIT: BRUSH

PHOTO N° 8

1

REF.

NAME

1. Horsehair brush Ø 100
2. Brush shaft
3. Guide flange (belt entri side)
4. Guide flange (motor side)
5. Brush driven pulley
6. Brush bearing bush
7. Brush brive shaft
8. Brush elevating crank
9. Brush elevation connecting rod
10. Brush lifting lever pins
11. Brush bearing
12. Adjusting bolt
13. Washer
14. Washer
15. Rigid ball bearings 6305-2RS (SKF)
16. Self-lubrificating bushing
17. Elastic belt FATEX Ø 10 x SV 940
18. Tab 8 x 7 x 30



FIG 8

SPARE PARTS

www.DaltonsWadkin.com

PAGE

UNIT: BELT CENTERING

PHOTO N° 9

1

REF.	NAME	
1.	Electronic centering solenoid valve	
2.	Power supply protecting case	
3.	Photoelectric cell support	
4.	Photoelectric cell support	
5.	Photoelectric cell	
6.	Electronic centering power supply	
7.	Pneumatic centering valve	
8.	Pneumatic centering support	
9.	Pneumatic centering support	
10.	Electronic centering panel	
11.	Pneumatic centering regulators	
12.	Air pressure regulator	
13.	Pressure gauge	
14.	Nut	
15.	Holding down stud	
16.	Cylinder articulated eye	
17.	Belt centering cylinder	
18.	Spacer	
19.	Locking ring	
20.	Spherical centre bearing	
21.	Adjustment support	
22.	Washer	

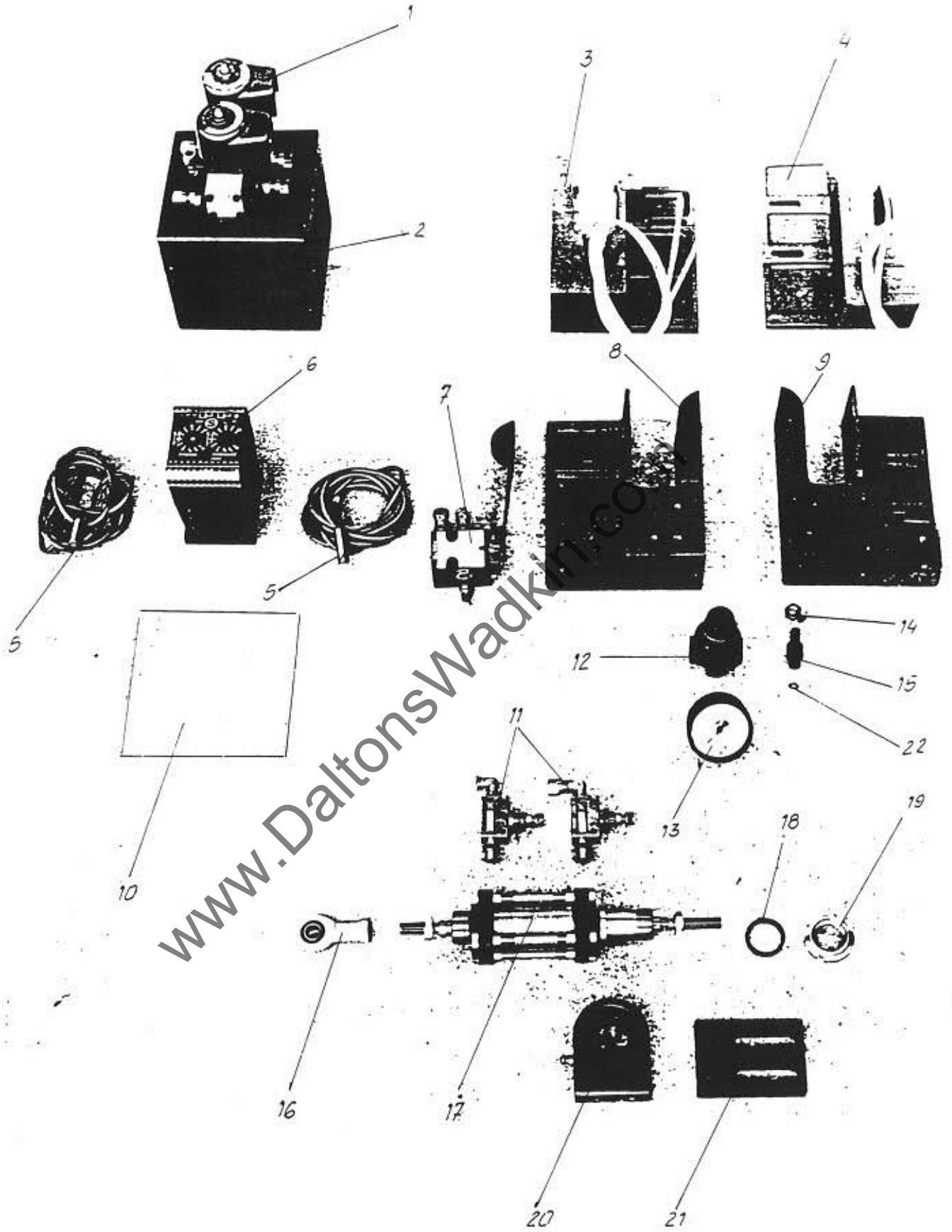

FIG. 9

SPARE PARTS

UNIT: TABLE WITH SECTIONED
FLOATING TABLES

PHOTO N° 10

REF.	NAME	
1.	Table with sectioned floating tables	
2.	Sectioned floating table	
3.	Equalizer	
4.	Lever	
5.	Anchor forks	
6.	Membrane clamping disks	
7.	Rubber closure caps	
8.	Membrane clamping plate	
9.	Membrane clamping ring	
10.	Membrane Colombo 15702	
11.	Fulcrum pins	
12.	Pins	
13.	Security dowels	
14.	Security dowels	
15.	Adjustment dowels	
16.	Adjustment dowels	
17.	Bearing SKF 6003-2RS (not illustrated)	
18.	Bearing SKF 6201-2RS (not illustrated)	
19.	Bearing SKF 6000-2RS (not illustrated)	

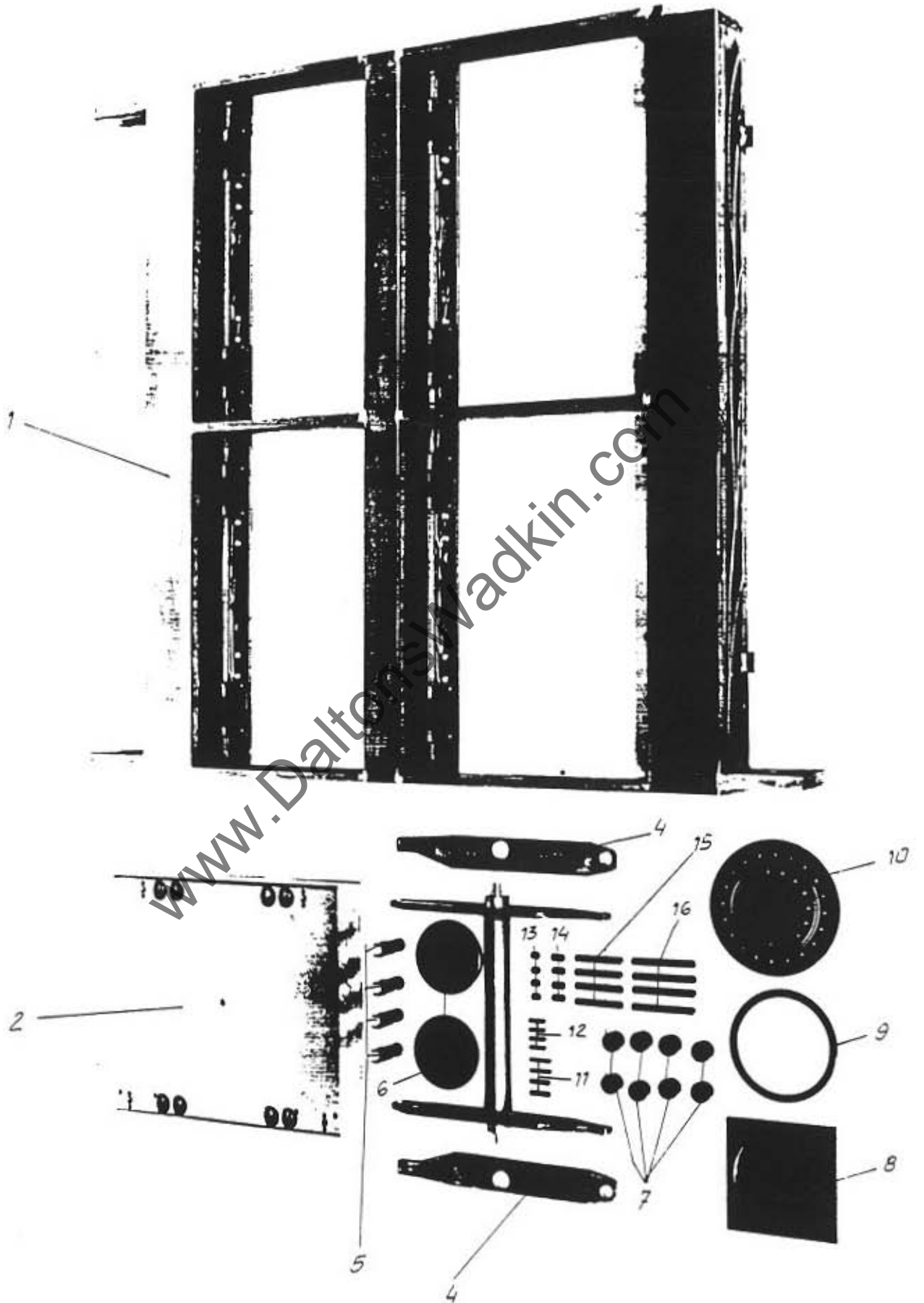

FIG. 10

SPARE PARTS

PAGE

UNIT: PAD

PHOTO N° 11

1

REF	NAME
1.	Rear roller
2.	Front roller
3.	Butt cover plate
4.	Pad section supporting rod
5.	Butt cover plate clamping support
6.	Bearing SKF 62207-2RS
7.	Bearing SKF 62207-2RS
8.	Pull-out locking handle
9.	Clamping tie rod
10.	Washer
11.	Bearing flange
12.	Bearing SKF 62208-2RS
13.	Closure flange
14.	Ring nut GUR M40 x 1,5
15.	Spacer
16.	Notched pulley
17.	Sheave
18.	Circlip E Ø 50
19.	Brush towing pulley
20.	Washer
21.	CHR 14 x 9 x 1 = 20
22.	Belt stretcher support
23.	Belt stretcher
24.	Bearings SKF 6203 - 2RS
25.	Circlip I Ø 40

SPARE PARTS

www.DaltonsWadkin.com

PAGE

UNIT: PAD

PHOTO N° 11

2

REF.	NAME	
26.	Circlip E Ø 15	
27.	CHR 14 x 9 x 1 = 20	
28.	CHR 12 x 8 x 1 = 50	
29.	CHR 8 x 7 x 1 = 20	
30.	Toothed belt pitch 1/2 Code 300H	

www.DaltonsWadkin.com

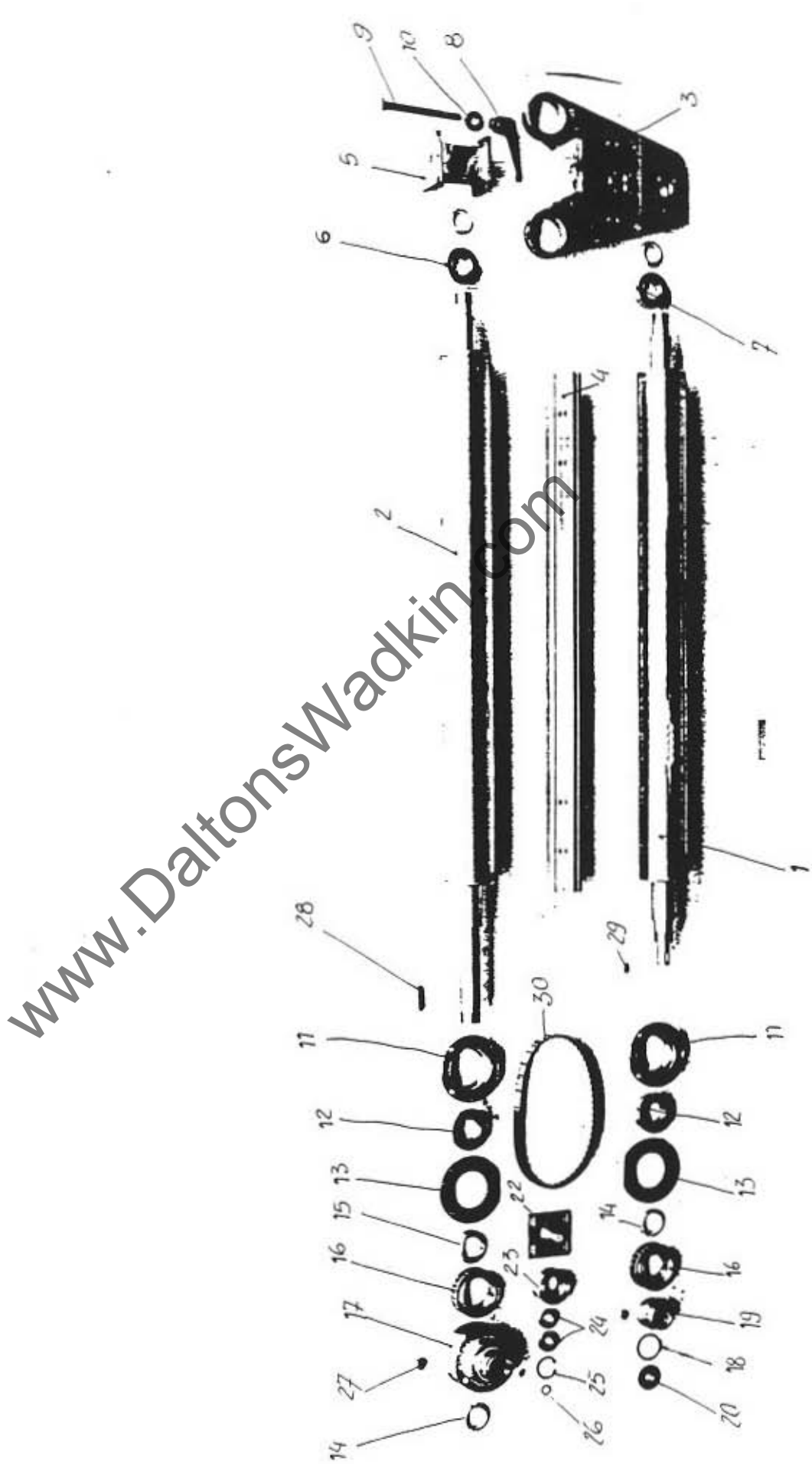

FIG. 11

SPARE PARTS

www.DaltonsWadkin.com

UNIT: PAD BEARING

PHOTO N° 12

REF	NAME
1.	Eccentric drive shaft
2.	Contact roller
3.	DR 4512
4.	Sealing ring
5.	Ball bearing series 61826 SKF
6.	Setscrew
7.	Ball bearing series 62211-2RS SKF
8.	Bearing stop flange
9.	Pulley spacer
10.	Brake disk
11.	Driven pulley
12.	Selflocking ring GUP 42 x 1,5
13.	Control side eccentric
14.	CHR 14 x 9 x 50
15.	Selflocking shrink fit ETP 30/41/25
16.	Control side wheel
17.	Spacer
18.	Si Ø 55
19.	Control side bushing
20.	Brush driving pulley
21.	Selflocking ring GUP 40 x 1,5
22.	Bush cap
23.	Ball bearing series 62208-2RS SKF
24.	Pad roller bushing
25.	CHR 8 x 7 x 20

SPARE PARTS

www.DaltonsWadkin.com

PAGE

UNIT: PAD BEARING

PHOTO N° 12

2

REF

NAME

26. Idle roller
27. Ball bearing series 62207-2RS SKF
28. Selflocking ring GUP 35 x 1,5
29. Butt cover plate
30. SE Ø 30
31. Ball bearing series 6006-2RS SKF
32. Rotary deviator A44166
33. Driven gear
34. Washer
35. Selflocking ring M 40 x 1,5 GUP
36. Roller bearing series 62208-2RS SKF
37. Belt entryside eccentric
38. CHR 8 x 7 x 15

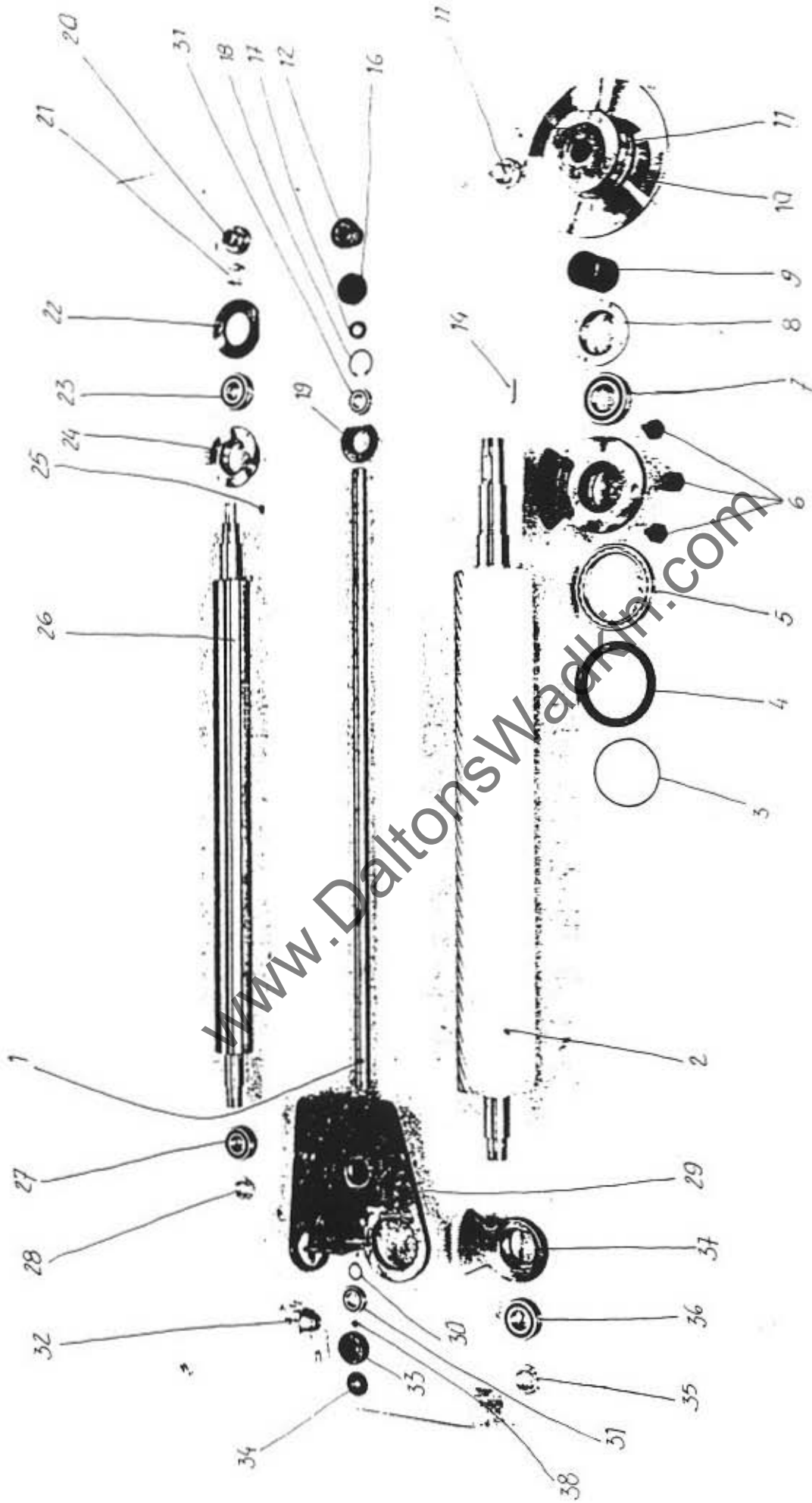

FIG 12

SPARE PARTS

www.DaltonsWadkin.com

PAGE

UNIT: CONTACT ROLLER

PHOTO N° 13

1

REF	NAME
1.	Contact roller
2.	OR 4512
3.	Sealing ring
4.	Ball bearing series 61826 SKF
5.	Setscrew
6.	CHR 14 x 9 x 45
7.	Ball bearing series 62211-2RS SKF
8.	Bearing stop flange
9.	Brake disk
10.	Driven pulley
11.	Selflocking ring GUP 45 x 1,5
12.	Spacer
13.	Selflocking shrink ETP 30/41/25
14.	Control side wheel
15.	Spacer
16.	Si + 5
17.	Ball bearing series 6006-2RS SKF
18.	Control side bushing
19.	Eccentric drive shaft
20.	CHR 8 x 7 x 15
21.	Se Ø 30
22.	Ball bearing series 6006-2RS SKF
23.	Driven gear
24.	Washer
25.	Rotary deviator A44166

www.DaltonsWadkin.com

SPARE PARTS

www.DaltonsWadkin.com

PAGE

UNIT: CONTACT ROLLER

PHOTO N° 13

2

REF

NAME

- 26. Belt entry side eccentric
- 27. Ball bearing series 62208-2RS SKF
- 28. Selflocking ring GUP 40 x 1,5
- 29. Check pin
- 30. Washer
- 31. Handle NUOVO TECK GR-30-M14
- 32. Roller spacer block
- 33. But cover plate

www.DaltonsWadkin.com

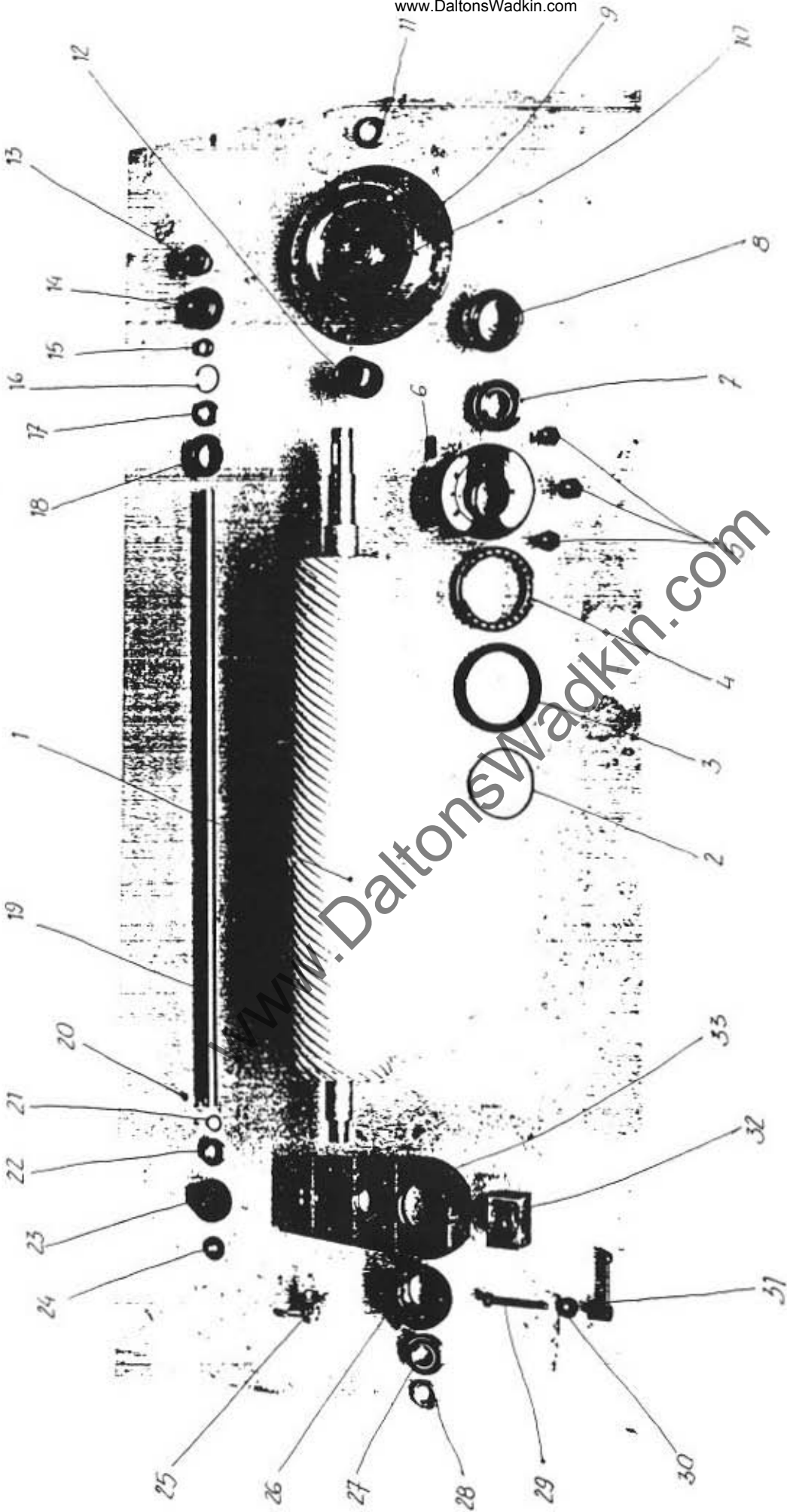

FIG. 13

SPARE PARTS

www.DaltonsWadkin.com

PAGE

UNIT: INTERMEDIATE PLATEN

PHOTO N° 14

1

REF	NAME
1.	Intermediate platen
2.	Platen gib
3.	Adjustment rod
4.	Platen bearing
5.	SE Ø 35
6.	Platen shaft bearing
7.	Platen bearing stop
8.	Platen spring coupler
9.	Pointer
10.	Adjusting bolt
11.	Spring stretcher
12.	Spring
13.	Spring stretcher
14.	Spring stretcher support
15.	Eccentric
16.	Rod bearing stop
17.	Rigid ball bearing SKF 6006-2RS
18.	SE Ø 30
19.	Platen clamping shaft
20.	Cylinder 1301-32-60-09 + Fork
21.	Platen elevating crank
22.	Eccentric
23.	Spring stretcher support
24.	Spring stretcher
25.	Platen shaft bearing

SPARE PARTS

www.DaltonsWadkin.com

PAGE

UNIT: INTERMEDIATE PLATEN

PHOTO N° 14

2

REF.

NAME

- 26. SE Ø 25
- 27. Platen gib
- 28. Rigid ball bearing SKF 6000-2RS
- 29. SI Ø 26
- 30. Small side bearing
- 31. SE Ø 10
- 32. Spring
- 33. Platen roller shaft
- 34. Platen roller
- 35. Small central bearing

www.DaltonsWadkin.com

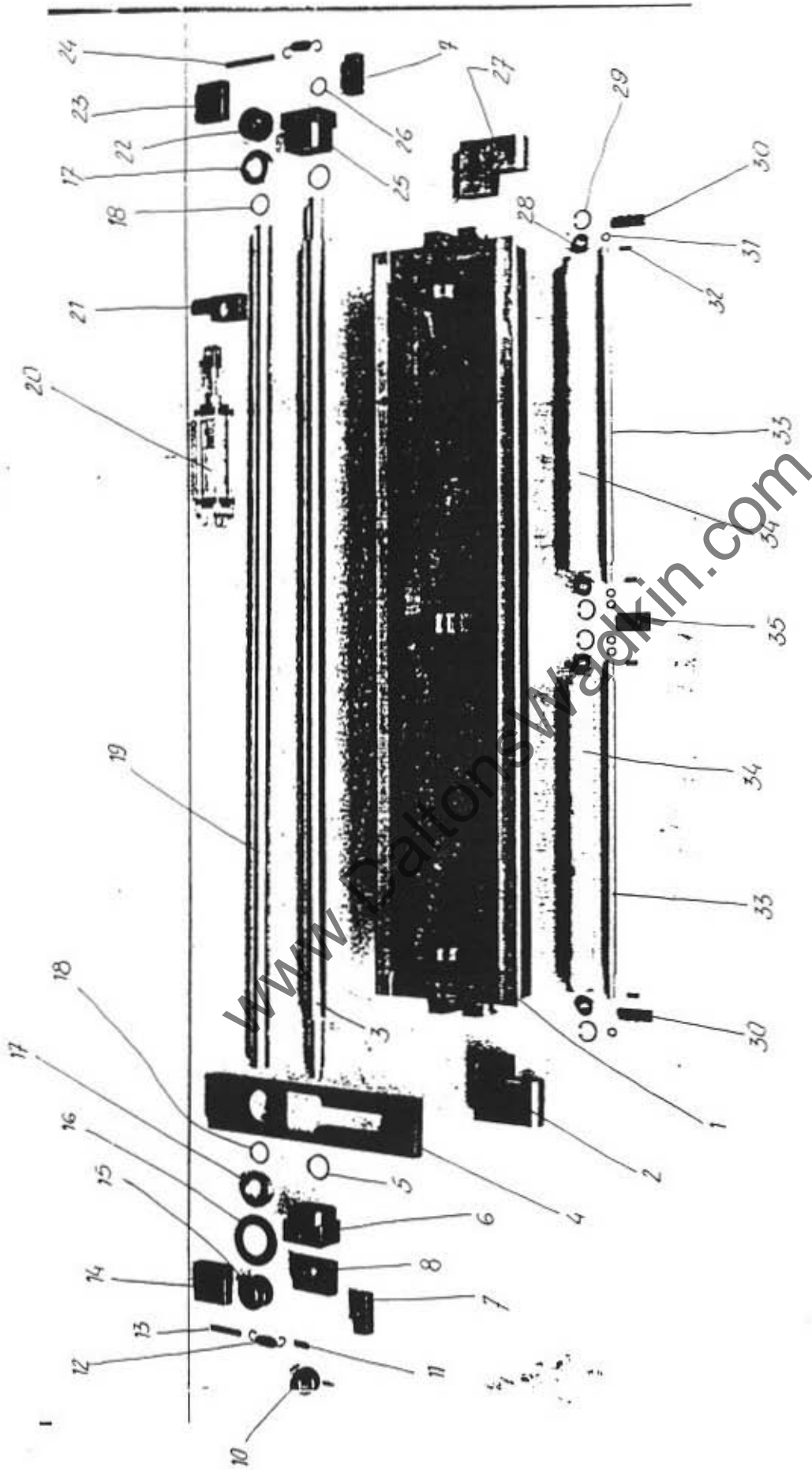

FIG 14

SPARE PARTS

www.DaltonsWadkin.com

PAGE

UNIT: REAR PLATEN

PHOTO N° 15

1

REF

NAME

1. Rear platen
2. Adjustment rod
3. Platen clamping shaft
4. Platen spring coupler
5. Rod bearing stop
6. Spring stretcher
7. Adjusting bolt
8. Jaccard handle
9. Pointer
10. Spring stretcher
11. Spring stretcher support
12. Platen bearing stop
13. Platen bearing
14. Spring
15. Small side bearing
16. SE Ø
17. Platen roller shaft
18. Small central bearing
19. Rigid ball bearings SKF 6000-2RS
20. SI Ø 26
21. Platen gib
22. Spring stretcher support
23. Spring
24. Spring stretcher
25. Platen shaft bearing

SPARE PARTS

www.DaltonsWadkin.com

PAGE

UNIT: READ PLATEN

PHOTO N° 15

2

REF

NAME

- 26. SE Ø 35
- 27. SE Ø 25
- 28. Grip eccentric
- 29. Rigid ball bearing SKF 6006-2RS
- 30. SE Ø 30
- 31. Platen elevating crank
- 32. Cylinder
- 33. Nipple
- 34. Hinge
- 35. Grip eccentric
- 36. Platen shaft bearing
- 37. Platen gib
- 38. Platen roller

www.DaltonsWadkin.com

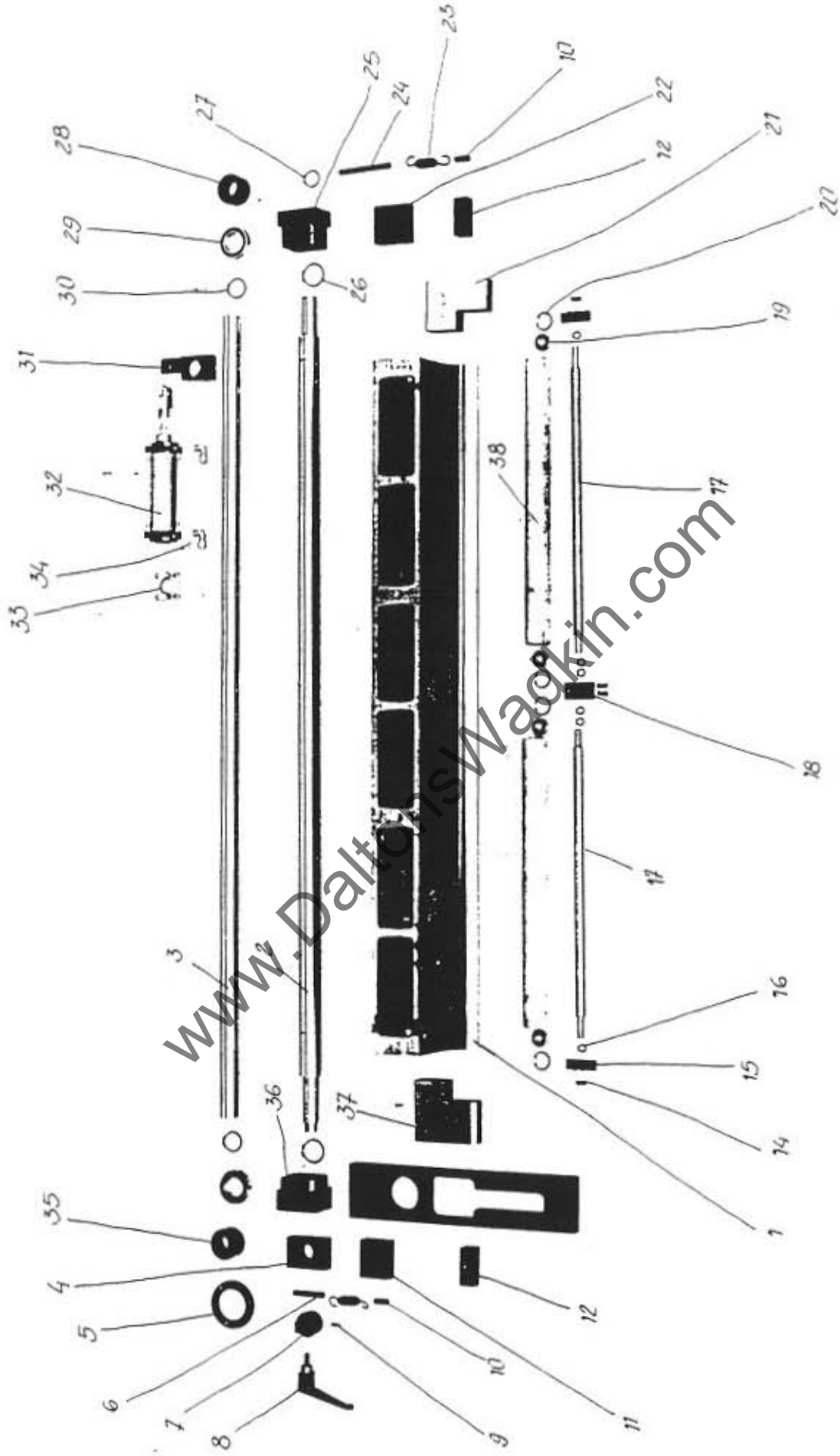

FIG. 15

SPARE PARTS www.DaltonsWadkin.com

PAGE

UNIT: OVERSIZE INTERMEDIATE PLATEN

PHOTO N° 16

1

REF.	NAME	
1.	Intermediate platen	
2.	Right bearing (control side)	
3.	Eccentric rod support	
4.	Platen bearing	
5.	Rod support plate	
6.	Eccentric rod	
7.	Platen clamping rod	
8.	Eccentric	
9.	Elevating crank	
10.	Platen roller shaft	
11.	Platen roller	
12.	Adjusting bolt	
13.	Pointer	
14.	Platen motion cylinder	
15.	Radial rigid ball bearing SKF 6006-2RS	
16.	SI Ø 55	
17.	SE Ø 30	
18.	Radial rigid ball bearing SKF 6000-2RS	
19.	SI Ø 26	
20.	SE Ø 10	
21.	Small side bearing	
22.	Small central bearing	

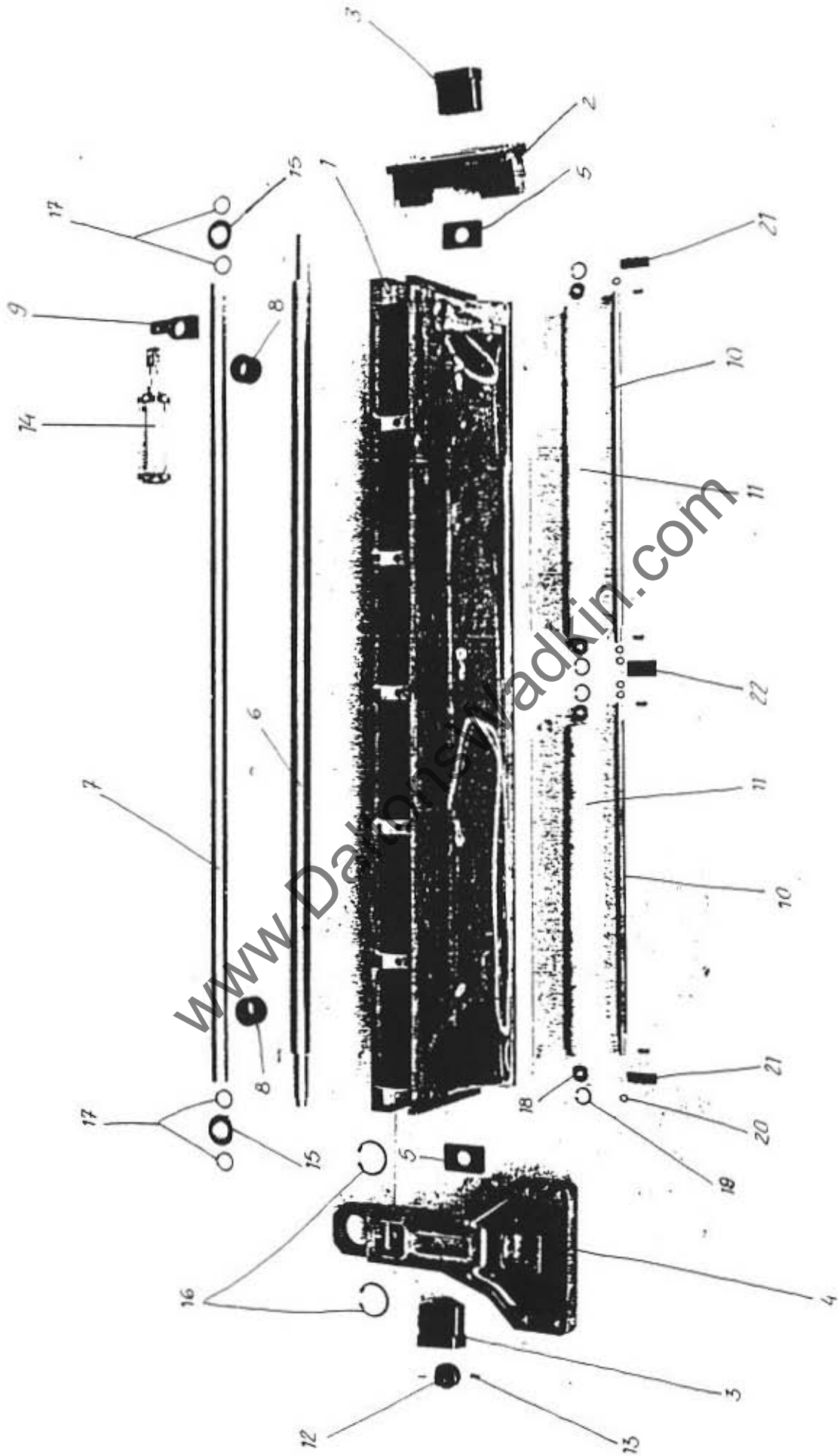

FIG. 16

SPARE PARTS

www.DaltonsWadkin.com

PAGE

UNIT: OVERSIZE ENTRY PLATEN

PHOTO N° 17

1

REF.	NAME	
1.	Platen bearing	
2.	Rod support plate	
3.	Needle-roller small bearing	
4.	Outer circlips Ø 12	
5.	Inner circlips Ø 28	
6.	Radial rigid ball bearings 6001-2RS (SKF)	
7.	Platen needle-roller	
8.	Entry platen	
9.	Right bearing (control side)	
10.	Eccentric rod support	
11.	Eccentric rod	
12.	Eccentric	
13.	Outer circlip Ø 30	
14.	Radial rigid ball bearing 6006-2RS (SKF)	
15.	Elevating crank	
16.	Platen motion cylinder	
17.	Platen clamping rod	
18.	Inner circlip Ø 55	
19.	Adjusting bolt	
20.	Pointer	

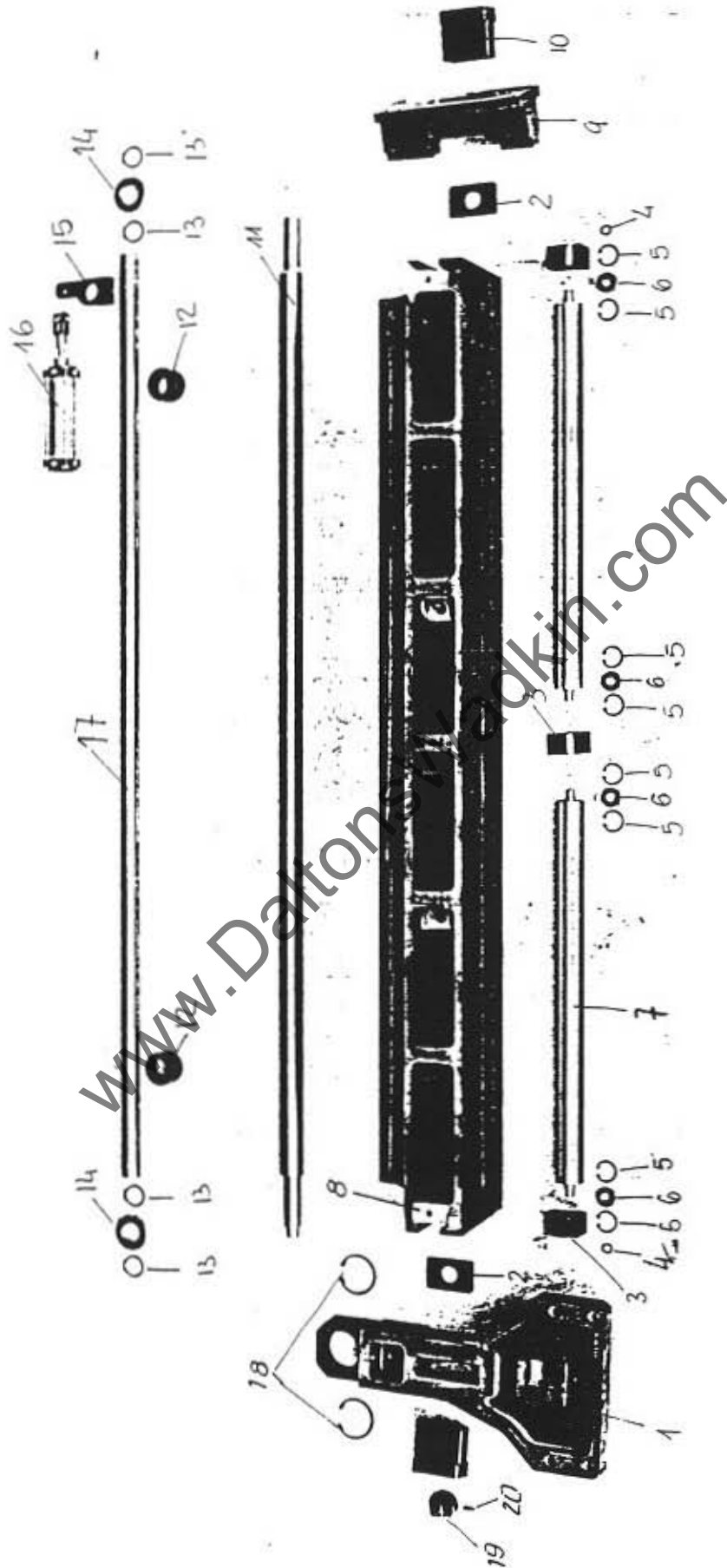

FIG. 17

SPARE PARTS

www.DaltonsWadkin.com

PAGE

UNIT: OVERSIZE EXIT PLATEN

PHOTO N° 18

1

REF.	NAME	
1.	Exit platen	
2.	Right bearing (control side)	
3.	Eccentric rod support	
4.	Platen bearing	
5.	Rod support plate	
6.	Eccentric rod	
7.	Platen clamping rod	
8.	Eccentric	
9.	Elevating crank	
10.	Platen needle-roller	
11.	Needle-roller small bearing	
12.	Adjusting bolt	
13.	Pointer	
14.	Platen motion cylinder	
15.	Radial rigid ball bearing 6006-2RS (SKF)	
16.	Inner circlips Ø 55	
17.	Outer circlips Ø 30	
18.	Radial rigid ball bearing 6001-2RS (SKF)	
19.	Inner circlips Ø 28	
20.	Outer circlips Ø 12	

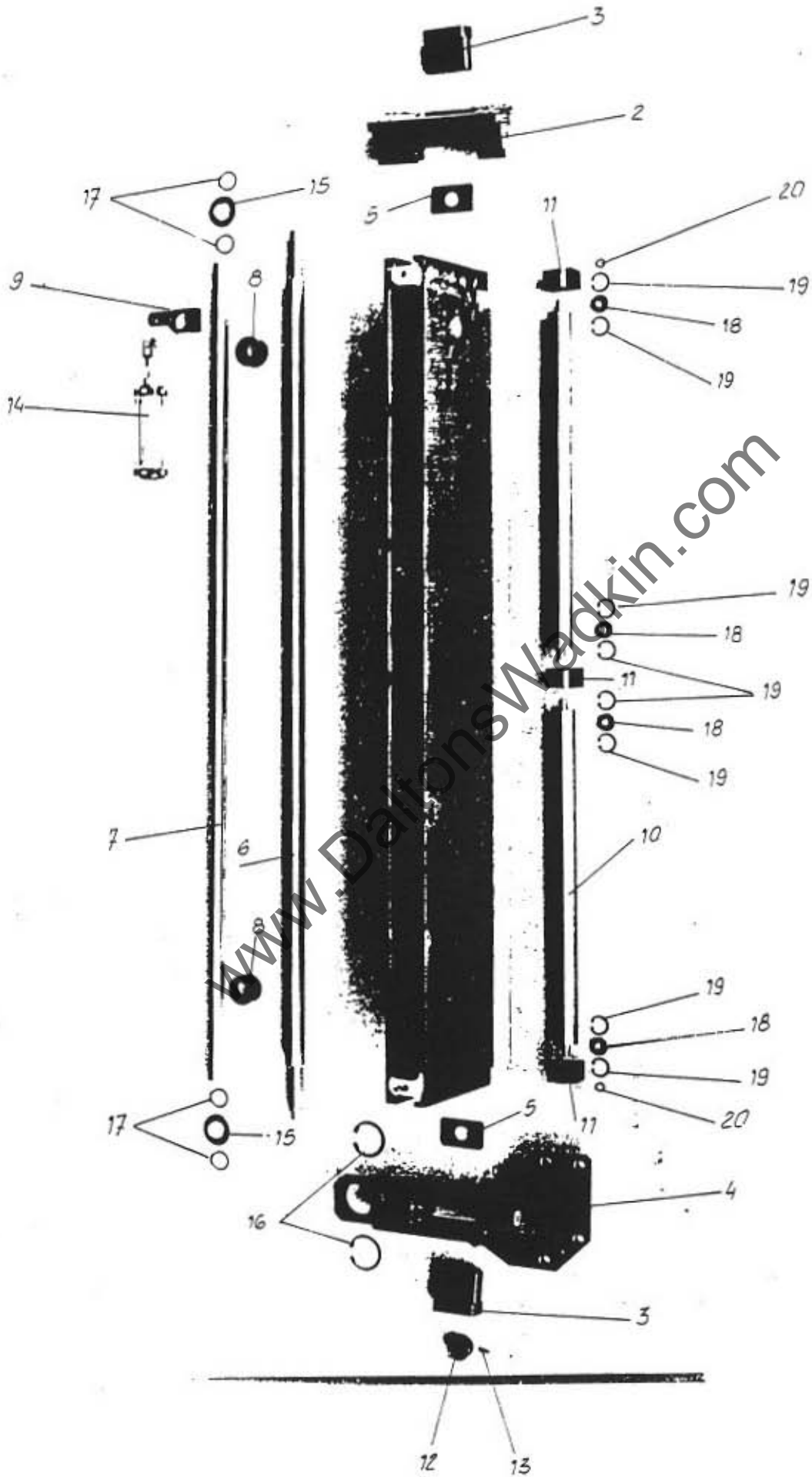

FIG. 18